

→ Spare parts overview | 9140 / 9160

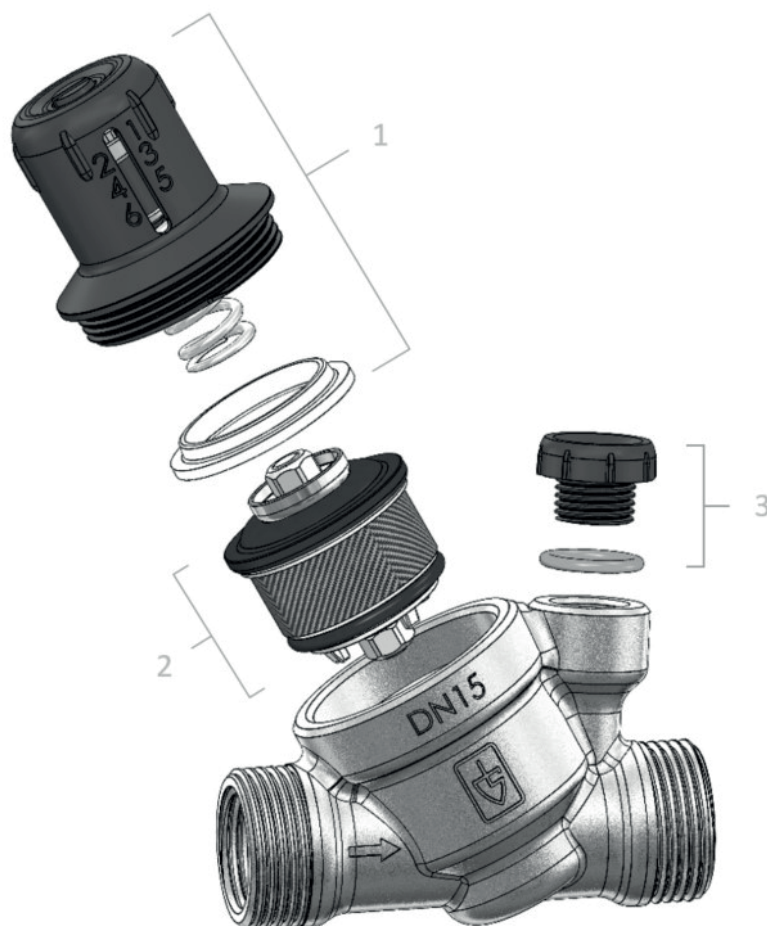

■ SINGLE PARTS 9060

No.	Description	Size	Item No.
1	Spring housing with adjusting spindle group and slide ring	DN 8	E9160.015.010
		DN 15	
		DN 20	
2	Valve insert with sieve	DN 8	E9160.015.020
		DN 15	
		DN 20	
3	Pressure gauge plugs ¼" with O-ring (5x)	DN 8	E9000.015.040
		DN 15	
		DN 20	
4	Screwed joint set 2x threaded nozzles 2x union nuts 2x seals	½"	E9000.015.030
		¾"	E9000.020.030
5	Pressure gauge 0 – 10 bar	DN 8	E9160.015.050
		DN 15	
		DN 20	

Subject to technical modifications. All documents / contents have been produced with utmost care.