

→ Series 9140



■ MATERIAL



■ SPECIFICATION



3/8"



+5°C to 60°C



Inlet pressure:
up to 16 bar
Outlet pressure:
1 - 6 bar

■ SUITABLE FOR

Potable water cold	up to 40°C	
Potable water hot	up to 60°C	

■ EXAMPLES OF USE

Protection of water-carrying appliances, machines and water supply systems against excessive supply pressure. Use of pressure reducing valves when a constant supply pressure is required in the system.

- Protection against overpressure
- Increased comfort and reduced water consumption

■ FEATURES

- Compact design, ideal for confined spaces in machines
- Adjustment scale for adjustment without pressure gauge / operating pressure
- Female thread G3/8"
- Filter screen with mesh size 350µm

■ APPROVALS

DVGW Hygiene | requested

Type approval ACS | requested

FDA | All materials in contact with the medium are FDA compliant

Requirements

DIN EN 1567	DVGW W270
DIN 4109	Elastomere guideline
UBA BWGL for metallic materials	KTW guideline

■ MATERIALS

Component	Material	DIN EN
Body	Stainless steel	1.4408
Valve insert	Plastic Stainless steel Elastomere	POM / 1.4301 / EPDM
Filter screen	Stainless Steel	1.4301
Spring housing	Plastic	PA Glass fibre reinforced
O-rings	Elastomere	EPDM
Plug	Plastic	PA Glass fibre reinforced

Series 9140 ■ VALVE VERSION

m	with diaphragm	High-quality, heat-resistant moulded elastomer membrane with fabric reinforced.
---	----------------	---

■ MEDIUM

f	liquid	For drinking water. Not suitable for steam. Other media on request.
---	--------	---

■ TYPE OF LIFTING MECHANISM

0	without lifting device
---	------------------------

■ OUTLET PRESSURE RANGES

SP	Standard version	Inlet pressure: up to 16 bar (PN 16)	Outlet pressure: 1 to 6 bar
----	------------------	--------------------------------------	-----------------------------

■ AVAILABLE NOMINAL DIAMETERS AND CONNECTION SIZES

Nominal diameter DN	8
Inlet	3/8" (10)
Outlet	3/8" (10)

■ TYPE OF CONNECTION INLET / OUTLET FLANGE CONNECTIONS

f / f	Standard DN 10 - 3/8	Female thread BSP-P / Female thread BSP-P	DIN EN ISO 228-1 / DIN EN ISO 228-1
-------	----------------------	---	-------------------------------------

■ SEALS

EPDM	Ethylene propylene diene	Elastomere moulded diaphragm and seals approvals according to drinking water directive
------	--------------------------	--

■ NOMINAL DIAMETERS, CONNECTIONS, INSTALLATION DIMENSIONS

Series 9140: Connection, installation dimensions, ranges of adjustment			
Nominal diameter	DN		8
Connection body male thread DIN EN ISO 228-1	G1		-
Connection body female thread	G2		G 3/8"
Inlet pressure	bar		max. 16
Operating temperature	°C		60
Outlet pressure range SP	bar		1 - 6
Installation dimensions in mm	l		65
	L*		-
	H		60
	h		17
	T1		21
	SW1		22
Pressure gauge connection DIN ISO228-1			1/4" radial
Weight	kg		0,29
Coefficient of flow Kvs	m ³ /h		1,9

*Threaded bushings are not included in the scope of delivery. Available as accessories.

■ MAIN DIMENSIONS, INSTALLATION DIMENSIONS

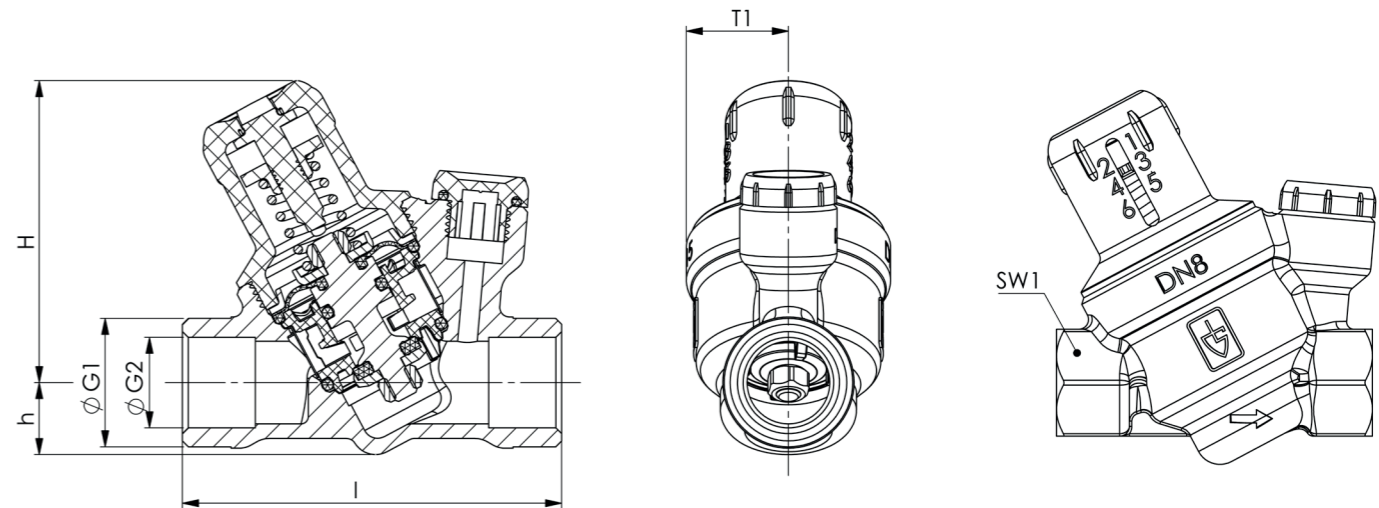

Series 9140 ■ INDIVIDUAL SELECTION / VALVE CONFIGURATION

Series	Valve version	Medium	Lifting device	Outlet pressure	Nominal diameter DN	Connection type		Connection size		Seal	Options	Optional: fixed setting	Quantity
						Inlet	Outlet	Inlet	Outlet				
9140	m	F	0	SP	8	f	f	10	10	EPDM			
9140													

■ PROPERTIES, VARIANTS, SUPPLEMENTS

S17	Supply with manometers 0-10 bar with PTFE Ring	<input type="checkbox"/>
A31	Supplied with connector John Guest 8mm	<input type="checkbox"/>
A31-1	Supplied with connector John Guest 8mm and Manometer 0-10 bar with PTFE Ring	<input type="checkbox"/>

■ APPROVALS

C01	Factory certificate acc. DIN EN 10204 2.2 (WKZ 2.2)	<input type="checkbox"/>
C02	Test certificate acc. DIN EN 10204 3.1 (WPZ 3.1)	<input type="checkbox"/>
C03	Material test certificate acc. DIN EN 10204 3.1 (MPZ 3.1) (pressure retaining part)	<input type="checkbox"/>
C05-1	Manufacturer certificates FDA	<input type="checkbox"/>

■ ENQUIRY

Copy and send to: order@goetze.de.

■ CAPACITY CHARTS

Series 9140:

Dimensioning by pressure loss on the outlet pressure side

Flow chart water

